

Sanitana



SENTRON

S50206200012600





1. PRODUCT FEATURES

1. Hygiene Sanitary

Sentron flushometer relies on infrared sensor to detect a user and activate a flushing cycle. No physical contact with the Flushometer surface is necessary, assuring sanitary protection.

2. Self-defense of auto-cutting electricity

In case of a power supply failure the sensor valve core is prepared to close automatically,

3. Water Saving

Economy flushing by 1 liter of water. Sentron flushometer is prepared to adjust the flush volume.

4. External LED

Different indicating lights show different sensing status.

5. Manual Flushing

The sensor has manual control button to control flushing manually.

6. Self-cleaning

When the urinal has not been used for a long time, the sensor will automatically flush every 24 hours to avoid the deodorizer and the sewer pipe from drying up.

7. Stable and reliable

The sensor applies high technology, that ensures reliable tightness of controlling wires and waterproof of connectors, hence to guarantee reliable function and long life.

8. Easy daily maintenance

The internal filter is easy to remove for cleaning.

2. COMPONENTS:

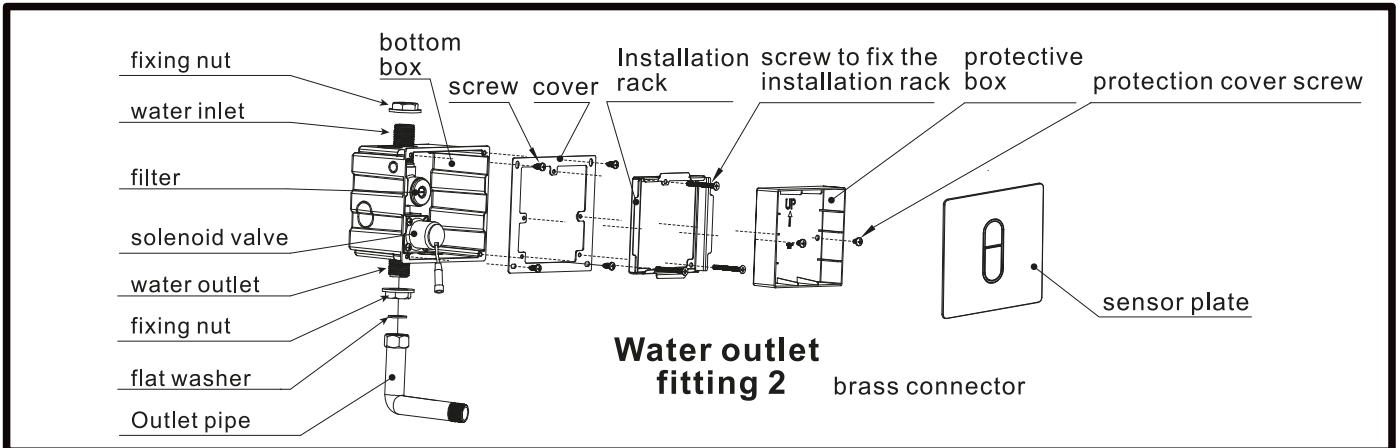

VERTICAL INLET

bevel nut
bevel seal
Covers
outlet seal
Brass pipe vertical outlet

HORIZONTAL INLET

Outlet seal
Ruber seal
Brass pipe Horizontal outlet

Water outlet fitting 3

urinal outlet

Universal accessory for AC and DC

universal power supply box
universal battery box



The instructions is composed based in the latest product specifications.
We reserve the right to make modifications to the instructions without providing prior notification.
Pictures for reference only , subject to our available products.



3. SPECIFICATION PARAMETER:

			<p>AC/DC:</p> <p>2 YEARS (4.000 CYCLES P\MONTH)</p>
			<p>100-240V,50/60Hz</p>

4. USAGE INSTRUCTIONS:

AUTOMATIC FLUSHING :

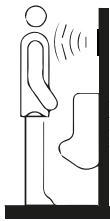

This flushometer identifies the presence of a target within sensing distance.

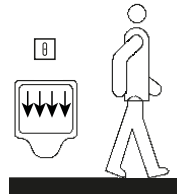

After the user (more than 6 seconds) moves out of the effective range of the sensor the flush cycle will be activated automatically.

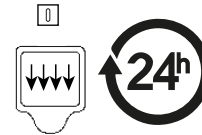

When the urinal has not been used for a long time, the sensor will automatically flush every 24 hours in order to prevent the proliferation of odors.

MANUAL FLUSHING :

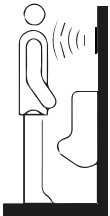

This flushometer identifies the presence of a target within sensing distance.

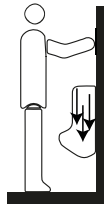

After usage, press down the button to activate flush cycle.

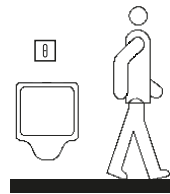

The sensor device will not flush again after the user moves out of the sensing range.

5. USAGE CAUTIONS:



THE FLUSHOMETER CONTAINS ELECTRONIC COMPONENTS

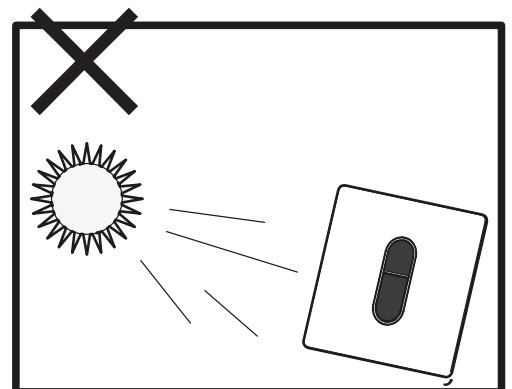
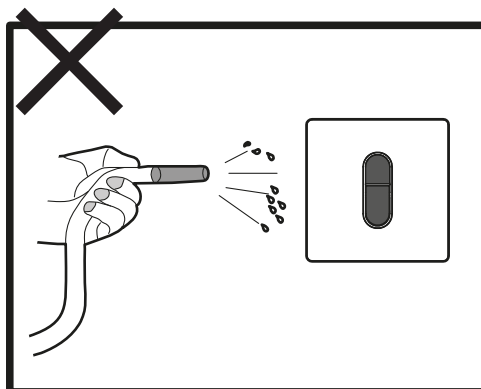
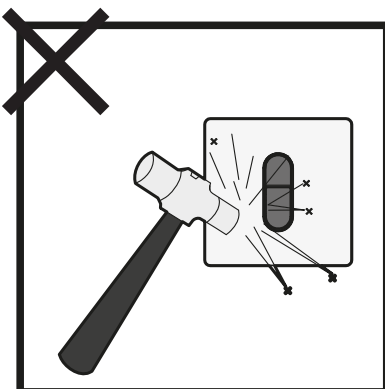

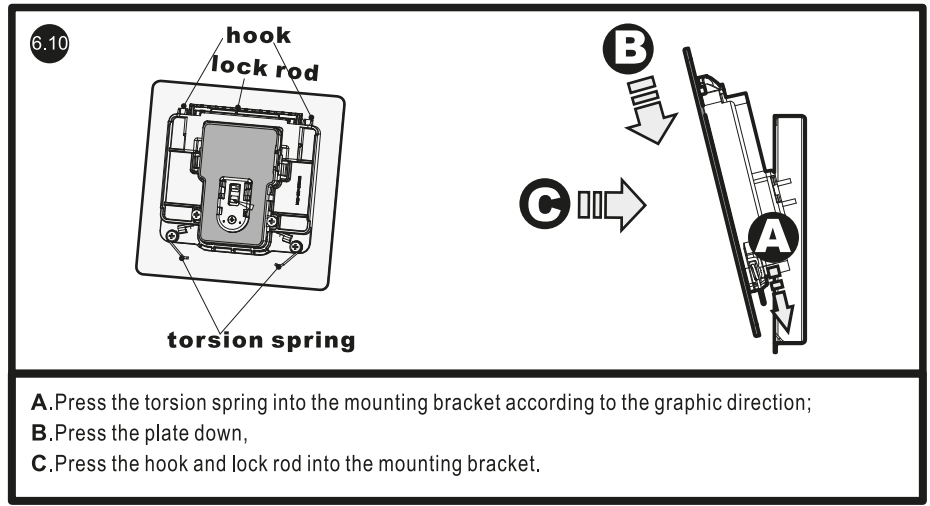
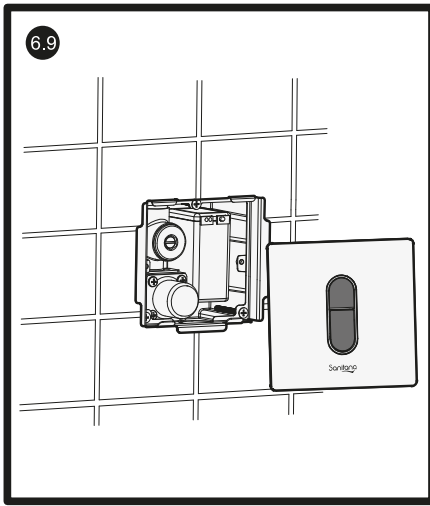

- A. Press the torsion spring into the mounting bracket according to the graphic direction;
- B. Press the plate down,
- C. Press the hook and lock rod into the mounting bracket.

7. REMOVING SENSOR PLATE

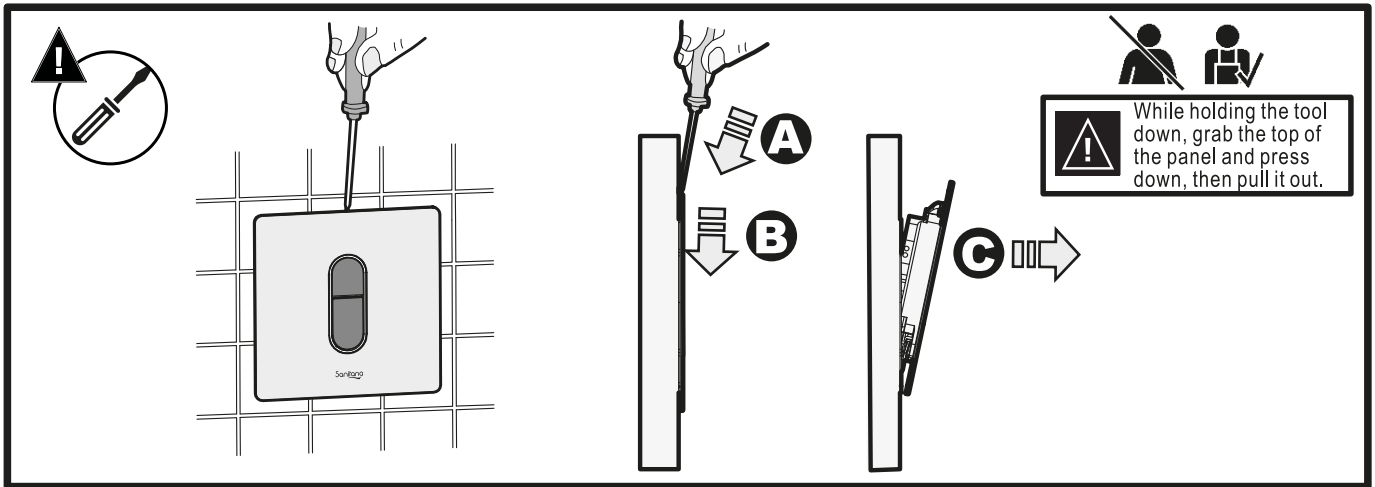

8. ADJUSTING FLUSH VOLUME PARAMETERS

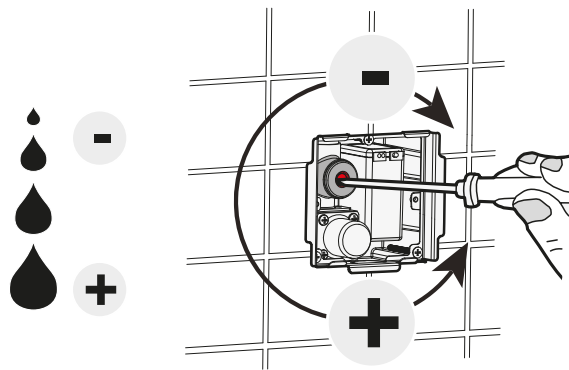

9. ADJUSTING FLUSH VOLUME PARAMETERS

The sensing distance can be adjusted by remote controller (default set ≈65cm).

- A. Press "D3 urinal sensor" button
- B. Choose "distance" button to "extend" or "shorten" the sensing distance by pressing "+" and "-"
- C. Press "OK" button to send the signal (ensuring that the controller is face to face to sensor plate)
- D. A rapidly flashing blue light will confirm the instruction.

Note: The distance increases or reduce about 3cm each time pressed.

The remote control is optional.

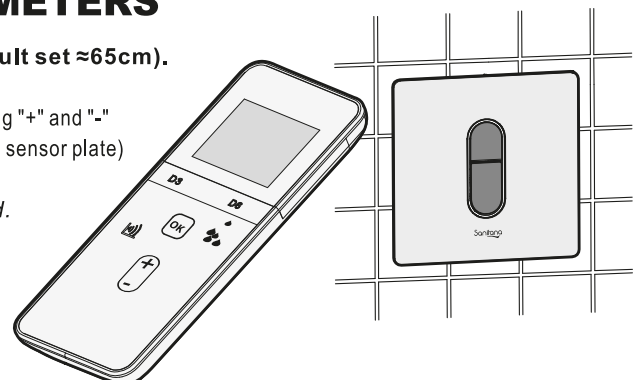

10. CLEANING AND MAINTENANCE

11.a - Maintenance and daily cleanliness

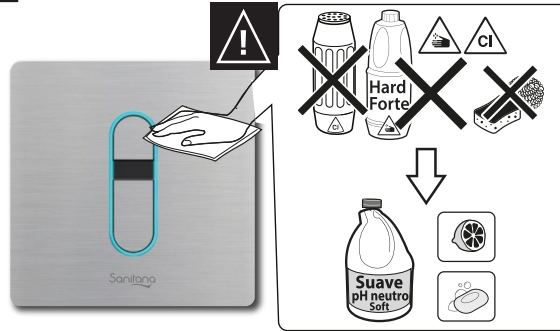
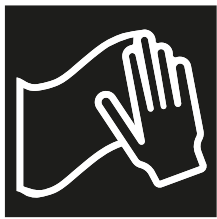

11.b - Filter maintenance

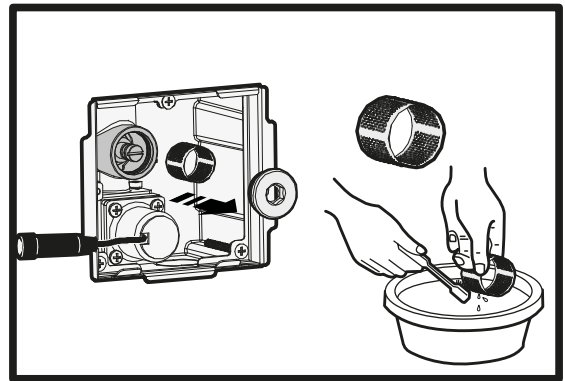
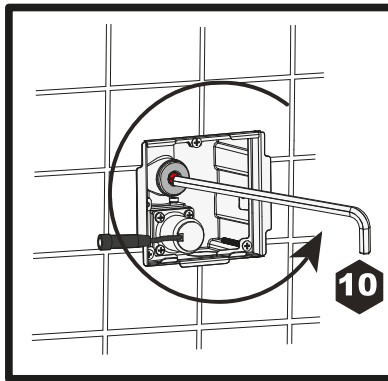
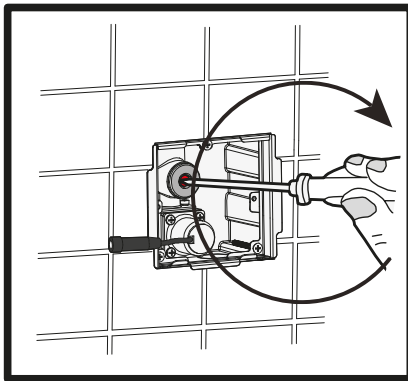

11. TROUBLESHOOTING



Issue	Cause	Resolution	Reference steps
No flushing	Sensor window needs cleaning.	Remove the dirt.	
	Water supply is cut off.	Connect water supply and wait for the water.	
	Filter is dirty and causes block.	Clean the filter.	Reference chapter (10)
	Water pressure out of operating range.	Adjust the water pressure to operating range.	
Water not shut-off.	The connecting wires between solenoid valve and sensing model falling off. (black wire)	Re-connect the black wire and sense for 10 seconds.	Reference chapter (6)
	Water pressure out of operating range.	Adjust the water pressure to operating range.	
	Water is dirty and impurities stuck at solenoid valve seal.	Clean the interior from the solenoid valve.	
Insufficient flush volume	Water volume is too small.	Adjust water volume accordingly	Reference chapter (8)
	Filter is getting dirty.	Clean the filter	Reference chapter (10)
	Operating pressure is too low.	Adjust the water pressure to operating range.	
Excessive flush volume	Excessive Flushing water	Adjust water volume accordingly	Reference chapter (8)
	Operating pressure too high.	Adjust the water pressure to operating range.	

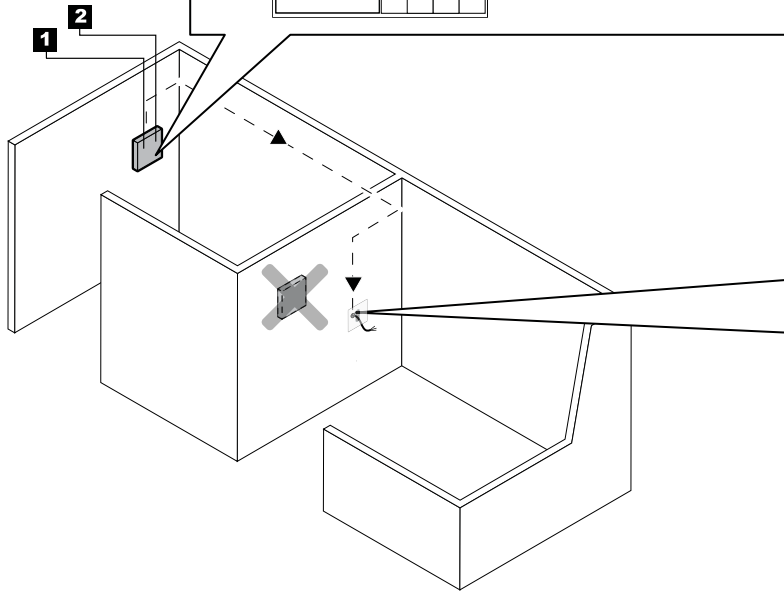
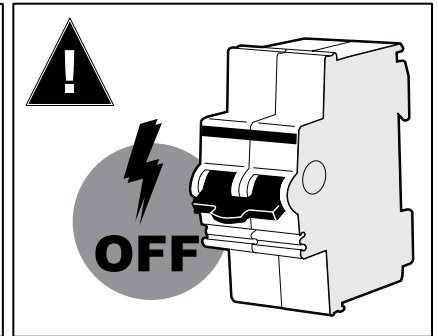
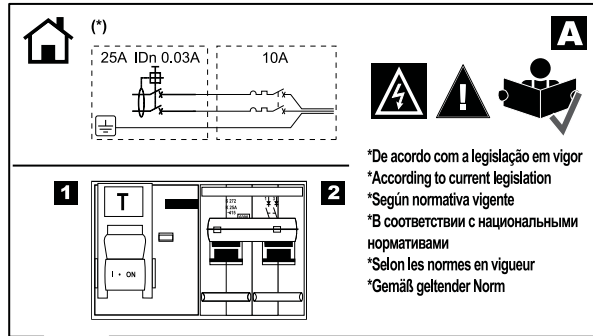

Obligatorio Обязательное соблюдение
 Mandatory Obligatoire
 Obrigatório Vorgeschrieben

!

B

3 x 1mm²
 L Min. = 300 mm

ØMin: 6 mm
 ØMax: 8,5 mm

C

V = Volume
 Volume
 Volumen
 Зона
 Volume
 Volumen

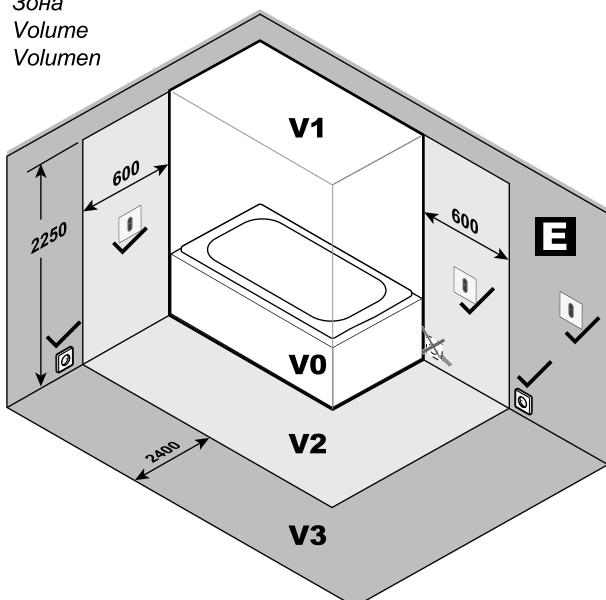

!

PT O Fluxómetro Sentron pode ser instalado na zona identificada como V2 (volume 2). Se o instalador optar pela alimentação eléctrica através de tomada de corrente terá que o fazer na zona identificada como V3 (volume 3). Esta recomendação é válida sempre e quando a norma em vigor aplicável no país de instalação o permita. Ter em atenção que este produto (grau de protecção IPX4) não pode ser exposto a jatos de água durante a sua limpeza.

EN The Flushometer Sentron may be installed in V2 zone (volume 2), although if connected to a wall-socket, it shall always be installed in zone V3 (volume 3). These recommendations are valid as long as the installation is compatible with the country regulations. This product (IPX4) shall not be exposed to water jets for cleaning purposes.

ES El Flushometer Sentron puede instalarse en la zona V2 (volumen 2), aunque en caso de conectarse mediante una base de enchufe, ésta debe estar siempre instalada en la zona V3 (volumen 3). Esta recomendación es válida siempre y cuando la normativa vigente en el país lo permita. Este producto (IPX4) no debe estar sometido a ráfagas de agua para su limpieza.

FR Ce Flushometer Sentron peut être installé en zone V2 (volume 2) mais la prise électrique doit toujours être installée en zone V3 (volume3). Cette recommandation est valide si l'installation est compatible avec les réglementations en vigueur dans le pays. Ce produit (IPX4) ne doit pas être exposé à des jets d'eau pour son nettoyage.



SANITANA, FÁBRICA DE SANITÁRIOS DE ANADIA S.A.
Zona Industrial de Anadia, Apartado 45 | 3781-909 Anadia (Portugal)
E-MAIL: info@sanitana.com | TEL: +351 231 519 500 | FAX: +351 231 511 504



As informações e medidas são a título orientativo e susceptíveis de modificações sem aviso prévio. Este documento anula os anteriores.
All information and dimensions should be considered merely approximate and are subject to modification without notice. This document cancels the former ones.
Toutes les dimensions et informations sont à titre indicatif et susceptibles de modifications sans préavis. Ce document annule les précédents.

Esta Empresa respeita a natureza, por isso, todos os nossos manuais são impressos com papéis que ajudam a manter o meio ambiente, utilizando pastas ECF provenientes de florestas renováveis.
This Company respects nature, and therefore all our manuals are printed with papers that help to maintain the environment, using only ECF pulp derived from renewable forests.
Cette société respecte la nature et c'est donc pour cela que tous nos manuels sont imprimés avec du papier qui aide l'environnement, en utilisant seulement les pâtes ECF provenant de bois renouvelables.

www.sanitana.pt | www.facebook.com/sanitana | assistencia.sanitana@sanitana.pt

SDRW-000086182-a